

CASSETTE SHADES CABLE GUIDE

Install shade before cable guide is mounted.

1. Spring and steel side cable have been installed at the factory.

Note: The steel cables have been attached to the cassette with pieces of tape. DO NOT remove the tape until you are ready to lock the cable guide in place. Avoid excessive movements to the cable; this may cause the spring to unhook from the bracket in the cassette.

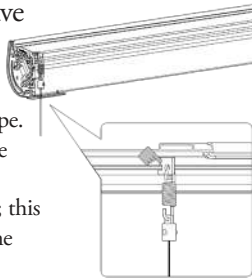

2. Install the side cable bracket (floor or wall mount). Use a steel tape measurer to determine placement.



Wall Mount Bracket



Floor Mount Bracket

3. Thread the steel side cable through the screw eye (on the bottom rail), the fastener, and the side cable bracket (wall mount bracket shown).

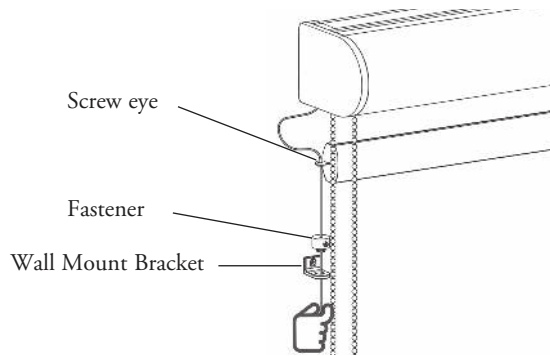

Screw eye

Fastener

Wall Mount Bracket

4. Determine the desired cable tension/length and use a hex key to tighten the Fastener into place (cut the excess steel cable with wire cutters). Lock the fastener into the floor or wall bracket. (DO NOT place the “safety plate” in the fastener until installation is complete).

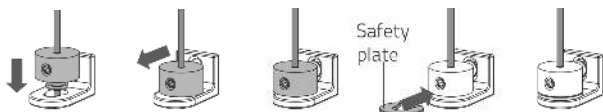

5. Follow steps 1-4 for both sides.

CHILD SAFETY

The tension device reduces the hazards of strangulation and entanglement of young children and pets by limiting access to the control loop.

The tension device must be installed to make the shade fully operational.

Pull tension device down until the chain is taut on both sides. Mark the upper screw hole, and using screws provided, install tension device with upper hole 3/8” above mark.

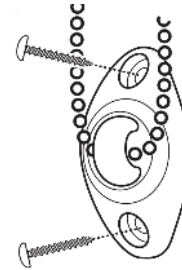

CARE AND CLEANING

Most roller shade fabrics are virtually maintenance free. Periodic feather dusting or vacuuming with a soft brush attachment and low suction will keep your shades clean and fresh.

Spills or stains can be lightly blotted with a damp cloth and water. Solar screen fabrics may be cleaned using a mild detergent.

Take care not to crease the fabric. Allow fabric to dry completely before raising the shade. Do NOT fully immerse.

Due to the differences in ultrasonic cleaning methods, we cannot recommend this method of cleaning.

EXTERIOR CABLE GUIDE

INSTALLATION & OPERATING INSTRUCTIONS

OPERATION

CLUTCH ROLLER

Continuous control loop offers precise shade positioning while the control remains the same length. Comes with tension device that must be mounted in order for the shade to operate.

CABLE GUIDE SYSTEM

Stainless steel cables connect to floor or wall mount brackets to stabilize the shade. Exterior cable system is meant for sun protection and will not withstand high winds. Not warranted against wind damage, shades must be pulled up in windy conditions.



Roller shade brackets must be LEVEL for the shade to roll up evenly.

OPEN ROLL SHADES

INSIDE MOUNT

Position the brackets at each end of the roller shade. Brackets may be mounted to wall, ceiling, or inside of window frame.

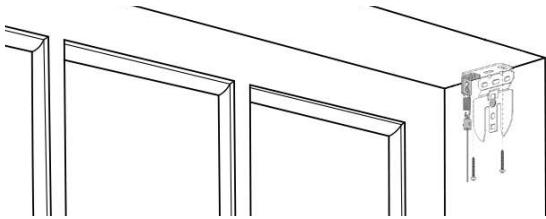

OUTSIDE MOUNT

The brackets are mounted back against the window casing or up against the ceiling.

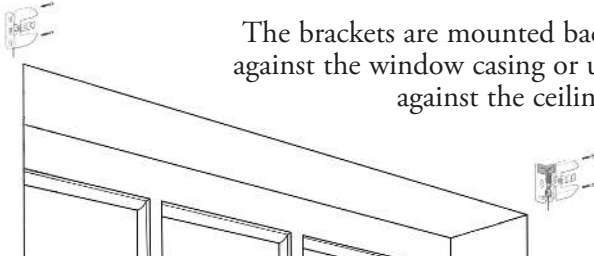

INSTALL THE SHADE

Lift the rolled shade up to the brackets with the fabric hanging closest to the window.

OPEN ROLL SHADES CABLE GUIDE

Install shade before cable guide is mounted.

1. Mount the side cable bracket. Attach the spring and cable to the bracket.

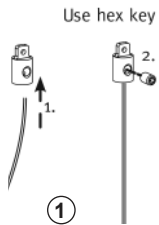
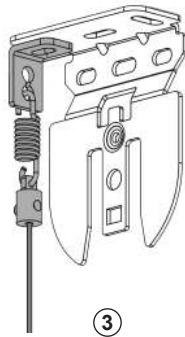

2. Install the open roll shade.

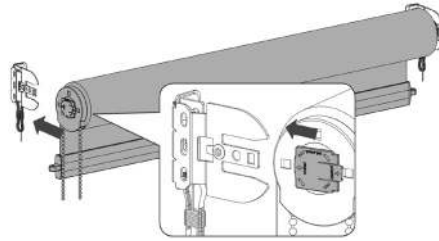

3. Install the side cable bracket (floor or wall mount).



Wall Mount Bracket



Floor Mount Bracket

4. Thread the steel cable through the screw eye (on the bottom rail), the fastener, and the bracket (wall mount bracket shown).

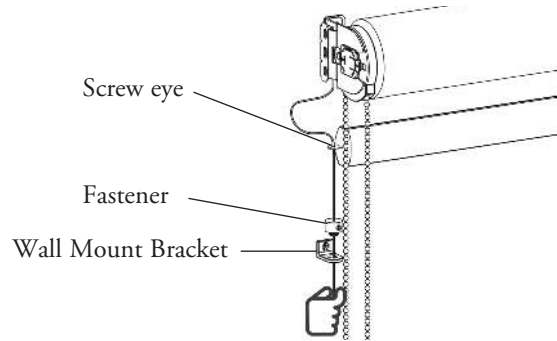

5. Determine the desired cable tension/length and use a hex key to tighten the Fastener into place (cut the excess steel cable with wire cutters). Lock the fastener into the floor or wall bracket. (DO NOT place the "safety plate" in the fastener until installation is complete).

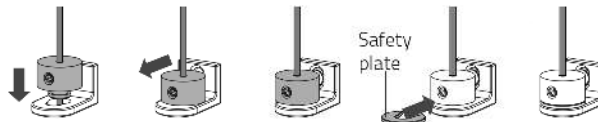

6. Follow steps 1-5 for both sides.

Roller shade brackets must be LEVEL for the shade to roll up evenly.

CASSETTE SHADES

INSIDE MOUNT

Position the first two brackets 2" from the ends. Evenly space any additional brackets between the two end brackets. Brackets may be mounted to wall, ceiling, or inside of window frame.

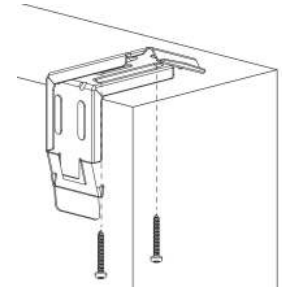

OUTSIDE MOUNT

The end brackets are mounted back against the window casing or up against the ceiling.

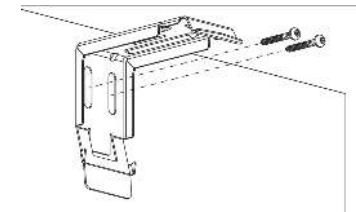

INSTALL THE SHADE

Position the headrail with the top panel (A) resting on the top hooks of all the brackets. Push the front of the headrail firmly back and up toward the window until the groove at the bottom of the headrail snaps into place (B).

